



schenckprocess



**Chain Conveyor**

## Chain Conveyor

In virtually every industry, Schenck Process Chain Conveyors are delivering robust, reliable performance over generations of use. They are used for conveying bulk materials, including coal, grain, gravel, ore, and ash. Chain Conveyors can also be used for heavy, lumpy materials and are satisfactory for withdrawing a continuous uniform flow of material from hoppers or storage bins. Capacities range from 10 tons to a formidable 2,000 tons per hour.

Schenck Process offers both conventional drag chain and en-masse chain conveyors. Equipment specification, machine sizing, and materials of construction are optimized for the specific application. To ensure absolute quality control, Schenck Process en-masse chains are made from high

tensile alloy steel forgings. For maximum strength and service life, the links are heat treated and the flights are precision welded to them. In each product, the same trademarks of quality, reliability, and cost-effectiveness maintain Schenck Process' reputation as a world class supplier.

Schenck Process' product range is extensive and diverse. Heavy-duty, gas tight, and high temperature machines serve the chemical, cement, mineral processing, and steel industries. Stainless steel clean line machines are available for the food industry. Schenck Process' world-leading, classic en-masse movement system provides a unique method of conveying bulk materials cleanly, gently, and economically.

**For more information, please contact us at 262-473-2441 or Fax: 262-473-6884  
E-mail: [mktg@schenckamericas.com](mailto:mktg@schenckamericas.com) Web site: [www.schenckamericas.com](http://www.schenckamericas.com)**

©2008 Schenck Process CC (6/08)

**we make processes work**

**Product Information**

## CHAIN CONVEYOR MODELS

### Design Features for the MC4000 Chain Conveyor



- Chain carried on wear-resistant and easily replaced manganese steel strip runners.



- New inspection doors ease access and improve installation speed.

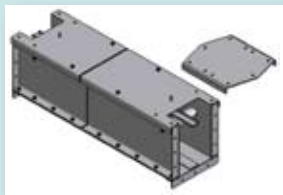

- Unique manganese wear strip inspection port.



- Quick and easy head and tail access for time-saving maintenance.



- Trailing wheels and drive sprockets segmented and bolted to hub.

- Indexed guide for accurate tension adjustment.



### Capabilities of the AF3000 Chain Conveyor

The most recent addition to the product family is the AF3000 conveyor designed specifically to handle bulk waste products including plastic scrap. The conveyor utilizes a simplified construction arrangement and deep UHMW flights to convey material into a boiler or other thermal process burner system.



### Schenck Process

746 E. Milwaukee Street  
Whitewater, WI 53190  
262-473-2441 or Fax: 262-473-6884  
E-mail: [mktg@schcnkamericas.com](mailto:mktg@schcnkamericas.com)  
Web site: [www.schcnkamericas.com](http://www.schcnkamericas.com)

schcnkprocess



we make processes work