



(Level 1 sanitary model shown)

schenckAccuRate



**MECHATRON®
"MC" Feeder**

MECHATRON® "MC" Feeder

Volumetric and gravimetric MECHATRON® "MC" Feeders feature a range of customer driven design attributes including AC or DC drive packages, "Coni-Flex™" flexible conical hopper, helix configurations for feed rates up to 330 cubic feet (9,300 liters) per hour and most importantly, the ability to disassemble, clean, reconfigure, and service from the non-process side of the feeder. MECHATRON® "MC" Feeders are perfectly suited for a wide range of volumetric or gravimetric applications involving food, pharmaceutical, chemical, and plastic materials.

MATERIALS OF CONSTRUCTION:

Contact materials –

- 304 & 316 stainless steel and UHMW Polyethylene.
- Coni-Flex™ chemical duty gray and FDA approved white vinyl.
- Coni-Flex™ chemical duty and static dissipative black polyurethane.

Non-contact materials –

- 304 stainless steel and epoxy coated cast aluminum.

FEED RATES:

- Helix diameters from .75" (19 mm) to 3.5" (89 mm) provide feed rates from 0.05 to 330 cubic feet (1.4 to 9,300 liters) per hour (theoretical).

FEED SCREWS:

- 304 or 316 stainless steel construction.
- Single screw, open flight or center-rod configurations.
- Full or half pitch configurations.
- Extensions to 48" (1.2 meters) from the feeder face.

CONI-FLEX™ FEED HOPPER:

- Removable 70 degree (from horizontal) conical flexible internal feed hopper.
- 1.2 cubic feet (35 liters) of material storage capacity.

HOPPER EXTENSIONS:

- 2.5, 7.5 and 13.2 cubic feet (70 to 375 liters) capacities with or without 10" (250 mm) inlet and 4" (100 mm) vent connections.
- Dust tight 360 degree band clamp mounting.

MOTOR SPECIFICATIONS:

- Industrial applications – single and dual AC (TEFC, 1/2 and 1 HP inverter duty) and DC (TENV, 1/2 HP) configurations.
- Sanitary applications – single and dual AC (TENV, 1 HP inverter duty) wash-down duty configurations.
- 230 VAC, single or three phase, 50/60 Hz.
- 460 VAC, 3 phase, 50/60 Hz.
- Explosion-proof motors available.

MOUNTING CONFIGURATIONS:

- Floor mount – 304 stainless steel tubular stand.
- Hanging mount – 304 stainless steel hanging flange.

WEIGH MODULE SPECIFICATIONS: (Optional)

- Dual Schenck stainless steel strain gage load cells. No summing box required.
- Weigh modules available in 441 lbs. (200 kg), 662 lbs. (300 kg) and 1,324 lbs. (600 kg) capacities.

PERFORMANCE:

- Volumetric accuracies of +/- 2% to 5% of feed rate setpoint typical at 2 sigma.
- Gravimetric accuracies of +/- 1/4% to 1% of feed rate setpoint typical at 2 sigma.



NOTE: Laboratory testing to determine specific material feeding accuracy is recommended and available from Schenck AccuRate.

**For more information, please contact us
at 1-800-558-0184 or Fax: 262-473-4384
E-mail: mktg@accuratefeeders.com
Web site: www.accuratefeeders.com**

Specifications

MECHATRON® "MC" Feeder

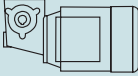
Specifications

EXTENSION HOPPER	MAINFRAME	SINGLE/DUAL DRIVE	GEAR RATIO	MOTORS	CONTROL	GRAVIMETRIC/ VOLUMETRIC
No Extension No Cover Manual Cover English Cover	Gray Vinyl	Single	Driver : Driven Helix : Agitation 14:45 (0.31) 18:40 (0.45) 24:36 (0.67) 26:32 (0.81)	 0.5 HP 50 Hz 0.5 HP 60 Hz 1 HP 50 Hz 1 HP 60 Hz	Mechatronic Remote Hanging	Gravimetric 2@132 lbs. (60 kg) 2@220 lbs. (100 kg) 2@331 lbs. (150 kg) 2@662 lbs. (300 kg)
7.5 cu. ft. (210 Liter) No Cover Manual Cover Din Cover English Cover	Toner Resistant	Agitation 0.5 HP 50 Hz 0.5 HP 60 Hz 1 HP 50 Hz 1 HP 60 Hz	Hanging	Volumetric 		
					13.2 cu. ft. (375 Liter) No Cover Manual Cover Din Cover English Cover	Static Dissipative

A FEEDER YOU CAN QUICKLY RECONFIGURE, CLEAN OR SERVICE FROM THE NON-PROCESS SIDE.



1 All components are accessible from the rear of the feeder instead of the discharge side. Simply remove back panel and loosen bolt.



2 Motor and drive assembly swings back for complete access to all internal components for cleaning, reconfiguration or maintenance.



3 Helix is easily removed allowing for quick helix style and diameter changes.



4 Release band clamp lever for hopper removal.



5 Hopper slides out for easy cleaning, replacement or maintenance.



6 Reposition motor and drive assembly. Tighten bolt and you're ready to run – all in under two minutes.

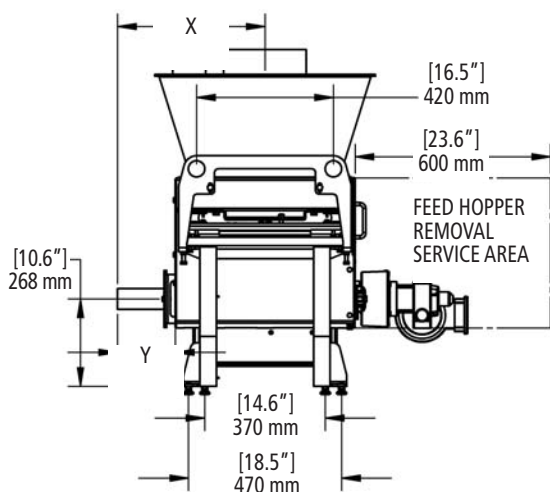
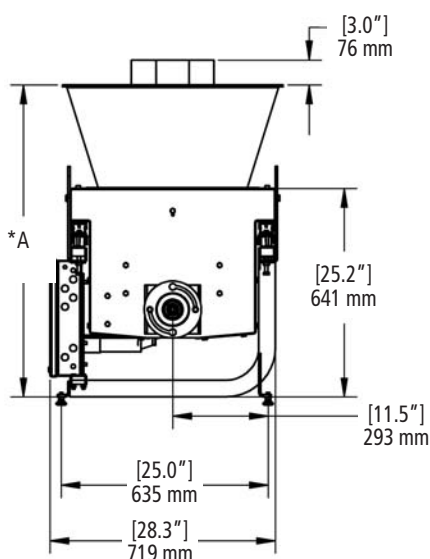
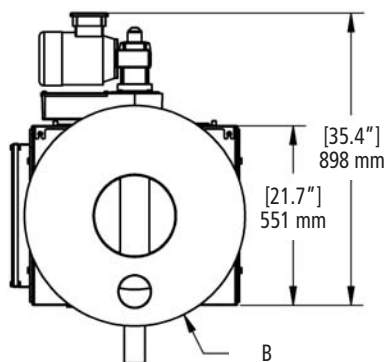

* Overall height of feeder is increased by .5" (12.7 mm) to 1.25" (31.8 mm) when using optional leveling feet.

	WEIGHT	HOPPER CAPACITY
FEEDER (Dead Load)	183 lbs. (83 kg)	1.2 cu. ft. (35 L)
EXTENSION HOPPERS		
75 L	16 lbs. (7 kg)	2.5 cu. ft. (75 L)
210 L	28 lbs. (13 kg)	7.5 cu. ft. (210 L)
375 L (2 pieces)	55 lbs. (25 kg)	13.2 cu. ft. (375 L)
COVERS		
Without ext. hopper	14 lbs. (6.4 kg)	
75 L	16 lbs. (7 kg)	
210 L	26 lbs. (12 kg)	
375 L	26 lbs. (12 kg)	
TOTALS		
Feeder + cover	197 lbs. (89 kg)	
Feeder + 75 L + cover	215 lbs. (98 kg)	
Feeder + 210 L + cover	237 lbs. (108 kg)	
Feeder + 375 L + cover	264 lbs. (120 kg)	
Stand + Feeder + cover	251 lbs. (114 kg)	1.2 cu. ft. (35 L)
Stand + Feeder + 75 L + cover	267 lbs. (121 kg)	3.7 cu. ft. (110 L)
Stand + Feeder + 210 L + cover	290 lbs. (131 kg)	8.7 cu. ft. (245 L)
Stand + Feeder + 375 L + cover	317 lbs. (144 kg)	14.4 cu. ft. (410 L)

Weights based on a single drive gravimetric system.

NOTES:

1. Standard infeed to discharge (X) is 19.7" (500 mm), with extensions to 59" (1,500 mm) in one inch increments. Standard distance from front face of feeder (Y) is 7" (178 mm) for helix diameter of 1.75" (44 mm) or larger and 8" (203 mm) for helix diameter of 1.38" (35 mm) or smaller.

2. System scale capacity:
 Total (2 Load Cells)
 264 lbs. (120 kg)
 441 lbs. (200 kg)
 662 lbs. (300 kg)
 1,324 lbs. (600 kg)

3. Cover is available in auto refill (shown), manual refill, or with no cover. Cover may be rotated up to 360° to meet application requirements. Standard inlet and vents:

	2.5 cu. ft. ext. hopper	7.5 & 13.2 cu. ft. ext. hopper
U.S.	10" Inlet - 4" Vent	10" Inlet - 4" Vent
European	150 DN Inlet - 100 DN Vent	200 DN Inlet - 150 DN Vent

4. Gearmotors available: .5 hp (.37 kw) or 1 hp (.75 kw), TEFC, IP-55. Meets NEMA MG-1 (parts 30 & 31).

5. Electrical service requirements:
 230V, 1 or 3 phase, 18.0 amps full load current, 50/60 Hz
 – or –
 460V, 3 phase, 10.4 amps full load current, 50/60 Hz
 FLA: 0.5 hp (.37 kw) = 5.0 amp (per motor)
 1 hp (.75 kw) = 9.0 amp (per motor)
 15.0 amp service is recommended for each motor

EXTENSION HOPPER DIMENSIONS

Capacity	Dim "A"	Dim "B"
2.5 cu. ft. (75 L)	37.7" (958 mm)	26.7" (677 mm)
7.5 cu. ft. (210 L)	49.8" (1,266 mm)	34.1" (866 mm)
13.2 cu. ft. (375 L)	61.7" (1,566 mm)	34.1" (866 mm)